



hainesmarine.co.uk

Haines 32 Sedan



Haines 32 Sedan



HAINES MARINE

Unlike mass production builders Haines combine traditional craftsmanship with modern techniques and will tailor a boat to individual requirements.

Ordering a bespoke Haines motor cruiser gives you the freedom to create a boat that is as individual as you are.

Enjoy an endless degree of choice from fabrics and linings to joinery finishes and even interior layouts.

The company based in the heart of the Norfolk Broads began life in 1980, and has since enjoyed international recognition as builders of high quality motor cruisers.

Haines 32 Sedan



Haines 32 Sedan



32 SEDAN

Offering amazing accommodation for her size, the Haines 32 Sedan is suitable for all river / estuary cruising with a range of engine options and Haines unquestionable build quality.

Light and airy throughout, with full opening 'slide and stack' patio doors connecting the saloon to the aft deck area. A retractable canopy concealed in the GRP peak that allows further light to flood in.

A craft designed with entertaining in mind, the large island double cabin forward, a spacious toilet wet room and a generous galley also provide excellent accommodation for those longer stays onboard.

Interior

SALOON

Large opening roof skylight and sliding openings to both side windows. Portside sideboard unit with fitted cupboard / drawers aft, and electrics panel cupboard beside helm position forward. Helm / dash with full instrumentation, leather bound stainless steel steering wheel and Morse control, footrest below helm. Outboard starboard settee with storage under (converting to full size double berth), and forward / aft facing settee with folding backrest. Hardwood rectangular table with hi/low freestanding leg, cocktail cabinet to aft starboard corner of saloon. Access to aft cockpit through full opening 'slide and stack' patio doors.

DECKS / AFT COCKPIT

Seating for 6 is comfortably provided, or 8 when incorporating the saloon aft facing seat with the patio door open. A large storage compartment is accessed through a lazarette deck hatch, a gas locker and storage locker under aft seating, with additional storage provided in port and starboard wing lockers. An overhanging GRP peak houses a retractable canopy. Aft gate gives access from the aft cockpit to the bathing platform, allowing easy boarding from either the side or the aft end. Steps from aft cockpit to the wide side decks are helped with the conveniently positioned hand rails. Grab rails run along cabin side to forward pulpit. The foredeck accommodates through-deck chain locker access, a manual anchor winch, bow roller, and either a galvanized anchor or mud weight.



Interior



GALLEY

Avonite worktop fitted with a 3 burner gas hob, through mounted waste bin and square stainless steel sink complete with drainage grooves. Large cupboard under sink, pots and pans storage under a stainless steel 30 litre gas oven, cutlery drawer above 65 litre refrigerator. An eye-level locker, a storage compartment below hinged step, and outboard shelving for crockery complete the large amount of storage offered in this spacious area.



Interior



FORWARD CABIN

Large island double berth with side steps and two large drawers below, access to chain locker forward of berth. Further large GRP storage box below berth, side shelves either side, extending aft from the chain locker bulkhead to the two large port and starboard wardrobes, both complete with hanging rails and hooks. Two flush-fit overhead escape hatches allow plenty of natural light and air flow into the cabin. Mirror and coat hook fitted to the aft bulkheads.

TOILET / SHOWER

Toilet/shower wet room with solid surface worktop and surface mounted ceramic sink with tall mixer tap. Manual toilet to waste tank, on raised solid surface plinth. Storage provided by outboard shelving and cupboard below sink. Wall mounted shower mixer tap with chrome shower head and hose.



Specification

Haines 32 Sedan

TECHNICAL SPECIFICATION

Displacement hull with a choice of shaft drive diesel engines, comfortable sleeping accommodation for 4. Designed and built to RCD Category 'C', a deep keel and large skeg protected propeller assist with low speed handling. Larger engine options gives the craft occasional coastal possibilities.

- Four-berth sedan cruiser
- Displacement hull for controllable slow-speed handling
- Single shaft drive diesel
- Suitable for river/estuary and occasional coastal use
- Bonded frameless windows
- Full opening 'slide and stack' patio doors
- Twin flush hatches to forward cabin
- Choice of interior timber finishes
- Wide non-slip decks
- GRP bathing platform with transom door for easy access
- Speeds to 9kts
- RCD Category C

SPECIFICATION

LOA	32ft 0ins	9.75m
Beam	11ft 6ins	3.51m
Draft	2ft 8ins	2.51m
Air Draft	8ft 3ins	0.81m

CAPACITIES

Fuel Tank: 40 gallons / 180 litres

Water Tank: 50 gallons / 225 litres

Waste Tank: 40 gallons / 180 litres

Calorifier Tank: 40 litres (complete with immersion)

ELECTRICAL

- 240v Shore connection
- 12v Electrical system
- 240v Sockets: 3 x double 240v sockets (to saloon, galley and forward cabin)
- 12v Sockets: 1 x cigar socket (to helm position)
- Batteries: 2 x 110amp domestic batteries, 1 x 110amp engine battery
- Immersion Heater
- Radio/CD (Bluetooth, USB and auxiliary in)
- Refrigerator: 65 litre
- Lighting (Interior): LED down lighters, pelmet lighting, steplights, wardrobe lighting, berth floor and berth reading lights
- Lighting (Exterior): LED deck lights with remote control

- Hull side steps with integrated LED lights
- Navigation Lights: Port, starboard, stern and steaming
- Horn: S/S twin trumpet horn
- Wipers: 2 x electric wipers
- Water Pump: Whale water pump
- Auto Bilge Pump: Whale electric bilge pump

HULL & CONSTRUCTION

- Bonded-In Tinted Windows
- Stainless Steel Rubbing Strake
- Stainless Steel Deck Cleats (x6)
- Stainless Steel Pulpit & Grab Rails
- Stainless Steel Water, Fuel & Holding Tanks
- Non-Slip GRP Deck Finish
- Fenders (x6) & Warps (x4)
- Bathing Platform for Rear & Side Access
- GRP Engine Vents with Stainless Steel Grill & Integrated Foot Step

SAFETY

- Electrical & Manual Bilge Pumps
- Auto Fire Extinguisher in Engine Compartment (2kg)
- Manual Fire Extinguishers (2 x 1kg)
- Fire Blanket
- Wide Non-Slip Decks
- Life Buoy & Boat Hook
- Anchor or Mud Weight with Chain, Anchor Bow Roller and Manual Winch

GAS SYSTEM

- Oven / Grill: Smev 30 litre oven and grill
- Hob: Smev 3-burner hob with glass top
- Gas Bottles: 2 x 3.9kg Propane gas bottles (including automatic changeover with OPSO)

MISCELLANEOUS

- Worktops: Solid surface worktops to galley and toilet compartment
- Outside Screen Cover or Interior Screen Curtains
- Saloon footstool
- Blinds or Curtains to windows
- Ensign / Staff: Ensign (1 yard) with stainless steel flag staff
- Steering Wheel: Stainless steel / leather bound steering wheel
- Canopy: Retractable canopy to GRP peak
- Teak Decking: Synthetic teak decking to bathing platform and side steps
- Pennant: Haines pennant

Standard 4 Berth

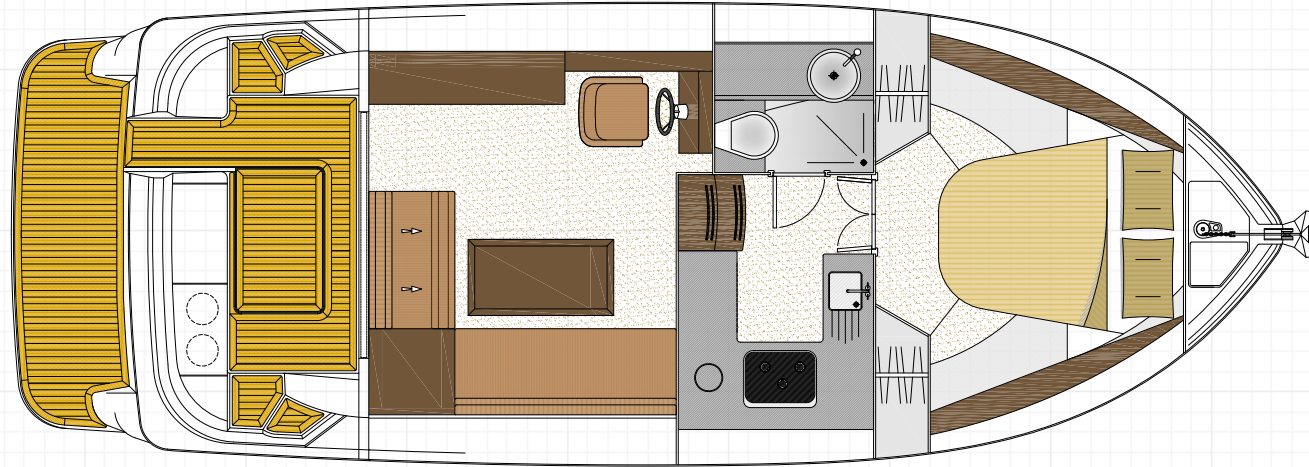

6 Berth Mid-Cabin

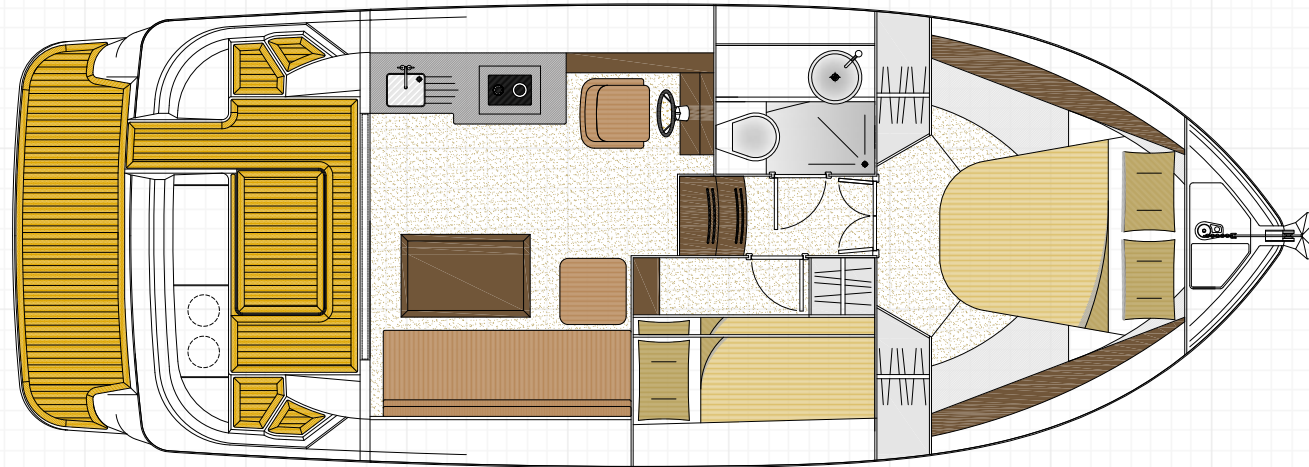







**HAINES**

hainesmarine.co.uk

Haines Marine
Old Mill Works
The Street, Catfield
Great Yarmouth, Norfolk
NR29 5DH

01692 582180

sales@hainesmarine.co.uk